

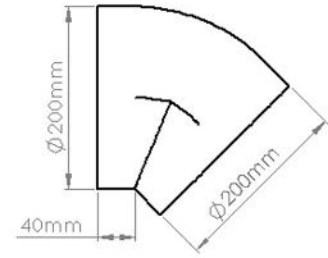

PRODUCT DATA SHEET
DUCSST-160-45B
 SELF-SEAL THERMAL 45° ELBOW

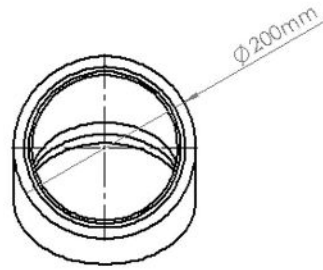

SPECIFICATION DETAILS

The Kair Self-Seal Thermal DUCSST-160-45B insulated fitting is manufactured from graphite impregnated expanded polystyrene (EPS) with a minimum density of 25kg/m³ and provides a free area of 20,108 mm². The DUCSST-160-45B is supplied with self-seal female couplings that allow the ducting fitted with a Duct to Fitting Connector to be plugged into the fitting apertures with a push, click and lock mechanism.

The Self-Seal female couplings are manufactured from prime High Impact Polystyrene and a Thermoplastic Elastomer Dynamic Sealing Gasket.

The EPS material is fully tested to meet the thermal conductivity requirements of BASF-EN13163 to assist with the prevention of condensation and is flame retardant to DIN 4102-B1.

Kair Self-Seal Thermal Fittings exceed the current UK Domestic Ventilation Regulation requirements of Part F 2010 Domestic Ventilation Compliance Guide and NHBC Guidance Document Chapter 3.2 and provide a thermal conductivity of 0.03 W/mK which at 20mm thickness gives a thermal resistance or R-value of 0.666 m²K/W.

The patent pending push, click and lock mechanism provides a low leakage solution which exceeds the requirements set out in DW/143 Class A leakage test and DW/154 ductwork standards.

The Self-Seal Thermal is compliant with the requirements outlined in the Energy performance characteristics database for use in SAP with MVHR and MEV supply and extract ventilation systems.

| | |
|------------------------------|--------------------------|
| Manufacturer: | Kair Ventilation |
| Part Number: | DUCSST-160-45B |
| Size: | 160mm Diameter |
| For use with: | Kair System 160 |
| Box quantity: | 6 |
| Individual Weight: | 207g |
| Colour: | Grey |
| Thermal Resistance: | 0.666 m ² K/W |
| Thermal Conductivity: | 0.03 W/mK |

MAX/MIN OPERATING TEMPERATURES

+ 60°C to - 15°C

PERFORMANCE CURVE

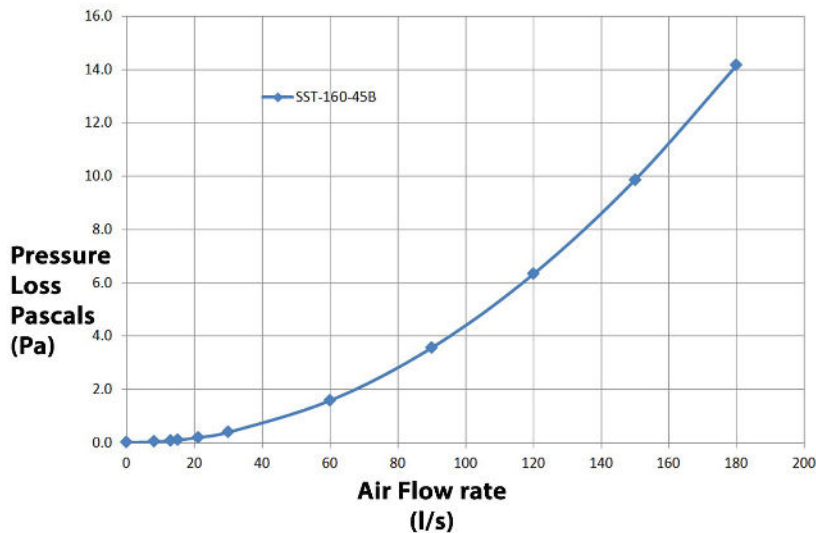

| AIRFLOW | RESISTANCE |
|---------|------------|
| 8 l/s | 0.00 pa |
| 13 l/s | 0.10 pa |
| 21 l/s | 0.20 pa |
| 30 l/s | 0.40 pa |
| 60 l/s | 1.60 pa |
| 120 l/s | 6.30 pa |

160mm 2m Thermal Duct

DUCSST-160-2M

160mm 1m Thermal Duct

DUCSST-160-1M

160mm Thermal 90° Elbow Bend

DUCSST-160-90B

160mm Thermal Equal T Piece

DUCSST-160-TP

160mm Thermal Condensation Trap

DUCSST-160-TRAP