

 IN-LINE FANS

100mm (4") ENERGY EFFICIENT (AXIAL)
GREEN LINE RANGE



- Exceeds 2010 Building Regulations
- Offers one of the lowest SFP's available at 0.22 W/(l/s)
- Uses up to 70% less power on standby than many other low energy fans
- Reduces carbon emissions by up to 60% (combined running and standby)



Technical data

Description	230V
Max Extract Volume (m ³ /h)	69.5
Max Extract Volume (l/s)	19.3
Max Pressure (Pa)	28
Supply Frequency (Hz)	50
Specific Fan Power W/(l/s)	0.22
Max Power (W)	4/Standby 0.2
Max Sound dB(A)@3m	34
Weight (kg)	0.45
IP Rating	X4
Max Temp (°C)	40
Wall-Fit Hole Diameter (mm)	-
Window-Fit Hole Diameter (mm)	-
Suitable Glass Thickness (mm)	-
Warranty	2 yrs

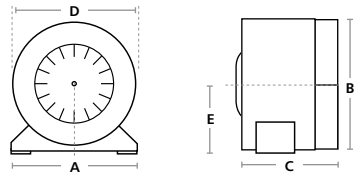
Dimensions



Measured in mm
A: 337 B: 294 C: 121 D: 100 E: 36 F: 74 G: 74

Performance

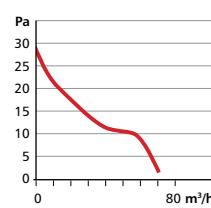
100mm (4") STANDARD (AXIAL)
DVF RANGE

- Concealed fan for discreet operation
- Ideal for shorter duct runs
- Available as a full kit or fan only



Technical data

Description	230V
Max Extract Volume (m ³ /h)	70
Max Extract Volume (l/s)	19
Max Pressure (Pa)	16
Supply Frequency (Hz)	50
Max Power (W)	12-20
Max Sound dB(A)@3m	32
Weight (kg) (Fan Only)	0.47
IP Rating	X4
Max Temp (°C)	40
Wall-Fit Hole Diameter (mm)	-
Window-Fit Hole Diameter (mm)	-
Suitable Glass Thickness (mm)	-
Warranty	2 yrs

Dimensions

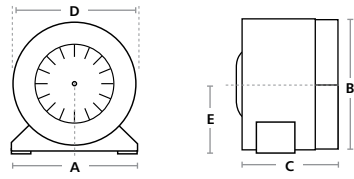

Measured in mm
A: 122 B: 100 C: 140 D: 100 E: 50

Performance

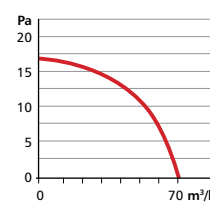
 IN-LINE FANS

100mm (4") STANDARD WITH LIGHT (AXIAL)
SPOTVENT RANGE

- Includes integrated light
- Concealed fan for discreet operation
- Ideal for shower application



Technical data

Description	230V
Max Extract Volume (m ³ /h)	70
Max Extract Volume (l/s)	19
Max Pressure (Pa)	16
Supply Frequency (Hz)	50
Max Power (W)	12-20
Max Sound dB(A)@3m	32
Weight (kg) (Fan Only)	0.47
IP Rating	X4
Max Temp (°C)	40
Wall-Fit Hole Diameter (mm)	-
Window-Fit Hole Diameter (mm)	-
Suitable Glass Thickness (mm)	-
Warranty	2 yrs

Dimensions

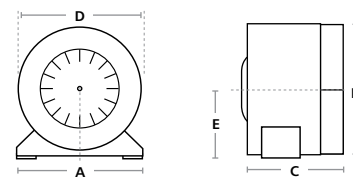

Measured in mm
A: 122 B: 100 C: 140 D: 100 E: 50

Performance

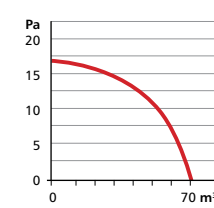
100mm (4") STANDARD (CENTRIFUGAL)
DVF RANGE

- Concealed fan for discreet operation
- Ideal for longer duct runs



Technical data

Description	230V
Max Extract Volume (m ³ /h)	80
Max Extract Volume (l/s)	22
Max Pressure (Pa)	150
Supply Frequency (Hz)	50
Max Power (W)	12-20
Max Sound dB(A)@3m	32
Weight (kg) (Fan Only)	0.47
IP Rating	X4
Max Temp (°C)	40
Wall-Fit Hole Diameter (mm)	-
Window-Fit Hole Diameter (mm)	-
Suitable Glass Thickness (mm)	-
Warranty	2 yrs

Dimensions

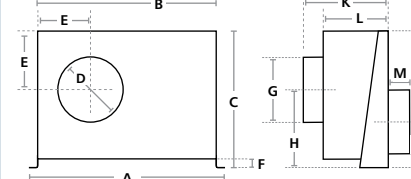

Measured in mm
A: 270 B: 220 C: 210 D: 100 E: 80 F: 15 G: 100
H: 130 I: 70 J: 98 K: 130 L: 100 M: 30

Performance

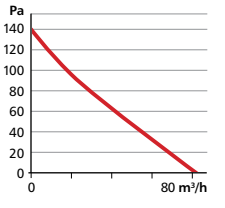

Models available	Includes Duct Kit				
	Pull Cord	Timer	Humidistat	PIR	
Code no.					
GLD100-T		●			
GLD100-TK	●		●		

Models available	Includes Duct Kit				
	Pull Cord	Timer	Humidistat	PIR	
Code no.					
DVF801D					
DVF802D					
DVF801ET	●				
DVF802ET	●				

Models available	Includes Duct Kit				
	Pull Cord	Timer	Humidistat	PIR	
Code no.					
SPV801ETWCG	●				
SPV802ETWCG	●		●		

Code no.	Accessories
SPV801TWCG	Light fitting only

Models available	Includes Duct Kit				
	Pull Cord	Timer	Humidistat	PIR	
Code no.					
DVF821ET	●				
DVF822ET	●		●		



Would you like help with selecting the most energy efficient appliance and duct system appropriate to your property? Please see page 87.